

LUXURY YACHT EXPERIENCES IN GREECE

www.deltayachting.gr

Our luxury yachts offer the perfect
blend of relaxation and adventure





ABOUT

Our love for sailing
compelled us to create
our business for you to
make the most of
yachting and touring
the Greek islands.

Delta Yachting is a business with a focus on the family. Our family of four began our journeys sailing the seas to share precious moments, create unique experiences and strengthen our family bonds.

We have built our business on the foundation of family, quality travelling and upscale yachts to provide a family experience along the famous Greek coastlines where unspoiled beauty meets endless sunsets, abyssal seas and a luxury boat to share the most precious moments beyond the walls of a hotel room.

Delta Yachting is an experience you won't want to miss.



Yacht Experiences



COLLECTION

At Delta Yachting, we offer a stunning collection of yachts for your next cruise vacation. Whether you're looking for a romantic getaway, a family vacation, or an adventure with friends, we have the perfect yacht for you.

Yacht collection





SAONA 47 NEFELI

ELEGANCE AND INDIVIDUALITY

10-12 5+1

DAYS

7/14

LOCATION

ALIMOS, ATHENS, GREECE

CHARTERS STARTING AT

3.955€ /PER WEEK + EXPENSES

Encompassing the finest signature features of the Fountaine Pajot shipyard, the Saona 47 exudes a striking aura with her distinctive design, strong lines and timeless elegance under sail or at anchor.

Incomparable space

The Saona 47 boasts expansive living areas for enhanced cruising pleasure. The generous cockpit is intelligently designed for entertaining and features an extended aft platform to easily facilitate a host of leisure activities. Immerse yourself in spectacular surrounds on the foredecks huge sun lounger or share in the cruising experience at the helmstation as you unwind on the exceptionally large 9m² lounge deck. The exquisitely crafted saloon is bathed in bright natural light, and her comprehensively equipped galley has an island bench and an abundance of storage for extended cruising.

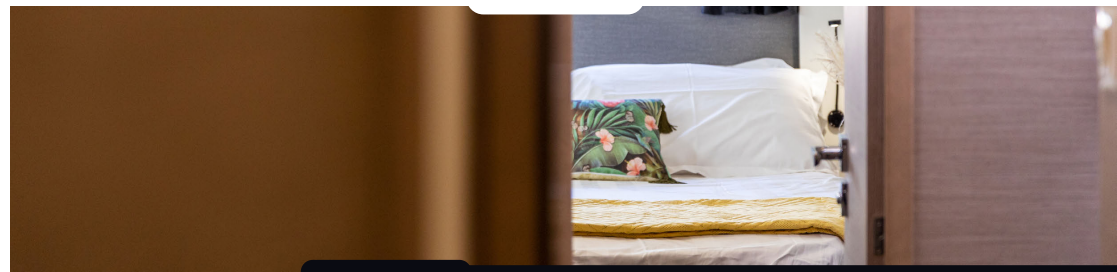

Available in two layouts, you can choose a 3-cabin Owner version featuring a decadent master suite that occupies an entire hull complete with Italian-style shower, plus two generous guest cabins in the port hull that each enjoy their own exclusive ensuites. The Saona 47 is also available in a five-cabin version with private ensuites to the four double guest cabins as well as to the convenient crew quarters.

Performance and Agility

The Saona 47 cruising catamaran offers intuitive responsiveness at the helm and unparalleled performance in all conditions. Her optimised weight-to-volume ratio delivers exceptional balance and stability for an unforgettable sailing experience at any speed. The Saona 47 a dynamic yacht delivering cruising pleasures designed to be shared!



SPECIFICATIONS

SAONA 47 NEFELI

MAIN FEATURES

Length over all • Longueur hors tout _____ 45.7 ft - 13,94 m

Beam over all • Largeur hors tout _____ 25.3 ft - 7,70 m

Displacement unloaded • Poids lège _____ 14.7 T (approx.)

Draft • Tirant d'eau _____ 3.9 ft - 1,20 m

Sail area • Surface Grand Voile _____ 828.8 saft - 77 m²

Genoa • Surface Génois _____ 559.7 sqft - 52 m²

Standard Power • Motorisation standard _____ 2 x 50 HP - 2 x 50 CV
Option: 2 x 60 HP - 2 x 60 CV

Architect • Architecte _____ Berret-Racoupeau Yacht Design

Interior design • Design intérieur _____ Racoupeau Design

RESERVOIR CAPACITY

Tank capacity • Capacité des réservoirs _____ 700 l (approx.) - 185 US gallons (approx.)
Fresh water • Eau douce

Fuel • Gasoil _____ 2 x 470 l - 2 x 124 US gallons (approx.)

Exterior



Interior



Quintet

Layout

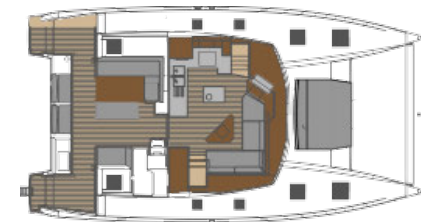
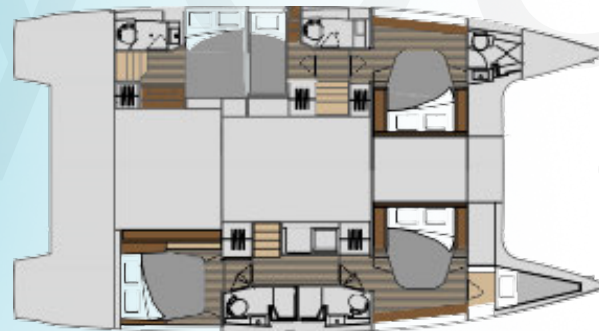

Saloon

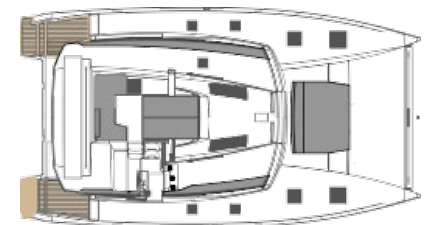

Deck

Quintet

5 cabins + 5 bathroom
5 cabines doubles + 5 sdb
Option : 1 crew cabin





MY 4.S MY ANGEL

XXL SPACES ON A PRESTIGIOUS MOTOR YACHT RATE

8 4

DAYS

7/14

LOCATION

ALIMOS, ATHENS, GREECE

CHARTERS STARTING AT

2.500€ /PER WEEK + EXPENSES

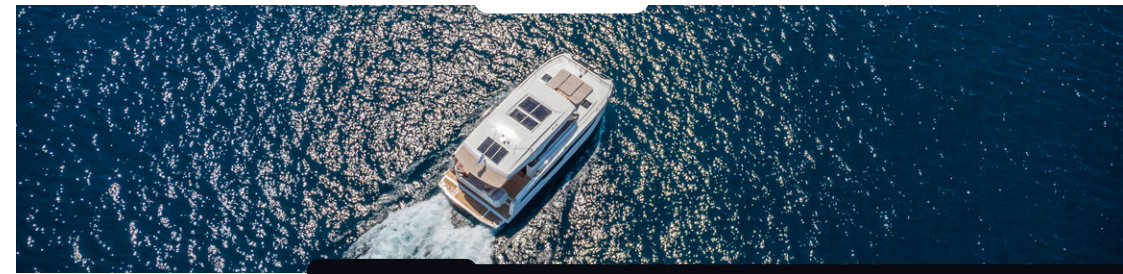

Feel at home in all the most beautiful bays in the world. And within your wake, the powerful satisfaction of a rare and refined luxury.

The oversized spaces aboard the MY4.S shake up all the preconceptions of monohull motor yachts of this size. Nearly a third more comfort, for a new and striking experience on real Motor Yacht catamaran hulls. Playing on the outside as well as on the inside, you will enjoy the exclusive pleasure of sovereign freedom with the new Sportop version. For the spectator in an ever-changing decor, every headland brings a promise of discovery.

From the privacy of your Fountaine Pajot MY4.S Motor Yacht, turning towards the magnetic horizon, nothing can stop your gaze.

And the day that's dawning is for you and only you. With the MY4.S, you're joining the prestigious Fountaine Pajot Motor yacht brand, and you'll be seduced by her sleek and elegant lines, her oversized interior spaces such as the Owner's cabin and saloon that's extremely bright with a sunroof (in option) and opening onto an ingenious cockpit with sunbathing area and extended by a rear platform for enjoying all the pleasures of the sea. Reaching speeds of up to 22 knots, the MY4.S combines elegance on the water with contemporary design. She will open up new horizons...



SPECIFICATIONS

MY 4.S MY ANGEL

MAIN FEATURES

Length over all • Longueur hors tout _____ 36.2 ft - 11,02 m without platform
40.0 ft - 12,20 m with platform

Beam over all • Largeur hors tout _____ 16.9 ft - 5,15 m

Displacement unloaded • Poids lège _____ 9.3 T

Full load displacement • Déplacement en charge _____ 15.1 T
maxi

Draft • Tirant d'eau _____ 2.7 ft - 0,80 m

Standard Power • Motorisation standard _____ YANMAR 2 x 110 KW - 2 x 150 Ch

Option Power • Motorisation option _____ YANMAR 2 x 186 KW - 2 x 250 Ch

Architect • Architecte _____ Daniel Andrieu

Interior design • Ambiance intérieure _____ Pierangelo Andreani Studio

RESERVOIR CAPACITY

Tank capacity • Capacité des réservoirs _____ 92 US gallons (approx.) - 350 | (approx.)
Fresh water • Eau douce

Fuel • Gasoil _____ 2 x 158 US gallons (approx.) - 2 x 600 | (approx.)

Autonomy • Autonomie Maxi _____ Up to 1000 NM

Exterior



Interior



Quatuor

Layout

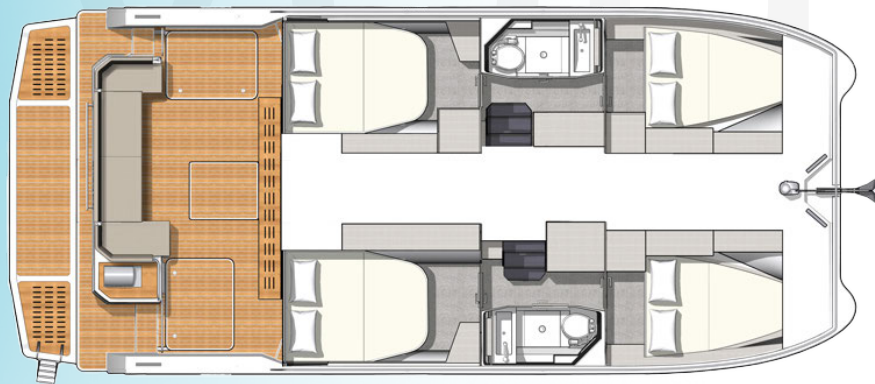

Quatuor

4 double cabins + 2 bathrooms
4 cabines doubles + 2 sdb

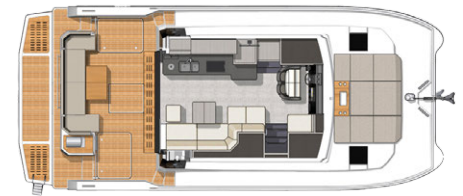

Deck

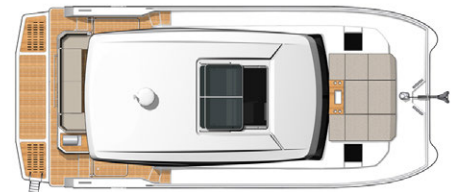

Deck



ELBA 45 O'NEIRO

A NEW CRUISING CATAMARAN TO EXCEED YOUR EXPECTATIONS

11 4+1

DAYS

7/14

LOCATION

ALIMOS, ATHENS, GREECE

CHARTERS STARTING AT

3.955€ /PER WEEK + EXPENSES

The Fountaine Pajot spirit is to face forward. The Elba 45 confirms in the most seductive way our taste for the avant-garde. This luxury catamaran is made to delight the eye and to take you by surprise. The energizing line of its inverted bows, the harmonious layout of its living quarters will mesmerize any enthusiastic yachtsman.

Dynamic and stylish, the helm of our new catamaran offers easy maneuverability and will delight you with its performance. A true cruising catamaran, traversed by a magnificent luminescence, you will feel aboard the Elba 45 just as comfortable as at home. With two new dedicated spaces in the saloon, you'll feel like you're in business class.

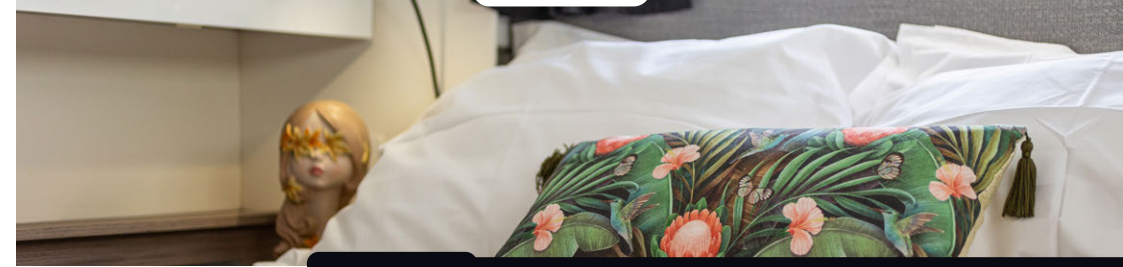

With the Elba 45, and its 13.45 metre size, all our creativity has been put to good use in meeting your expectations for comfort. We have oversized ordinary boating experience, with one of the largest lounge areas in its category, the Owner Suite and the breathtakingly large guest rooms, the 8.5 m2 relaxation areas at the front of the boat to enjoy the delights of the sea in the most relaxed way.

The Elba 45 is available in two versions. Maestro, with an Owner's suite and its ensuite bathroom, two double cabins and two adjoining bathrooms. Quatuor, with 4 double cabins and 4 adjoining bathrooms.

The Elba 45 defies moderation, in the name of the pleasure you will find in sailing.



SPECIFICATIONS

ELBA 45 O'NEIRO

MAIN FEATURES

Length over all • Longueur hors tout _____ 44.1 ft - 13,45 m

Beam over all • Largeur hors tout _____ 24.8 ft - 7,55 m

Displacement unloaded • Poids lège _____ 14.0 T (approx.)

Draft • Tirant d'eau _____ 3.9 ft - 1,20 m

Sail area • Surface Grand Voile _____ 807 ft² - 75 m²

Genoa • Surface Génois _____ 527 ft² - 49 m²

Standard Power • Motorisation standard _____ 2 x 50 HP - 2 x 50 CV

Architect • Architecte _____ Berret-Racoupeau Design

Interior design • Design intérieur _____ Racoupeau Design

RESERVOIR CAPACITY

Tank capacity • Capacité des réservoirs _____ 2 x 92 US Gallons - 2 x 350 l (approx.)
Fresh water • Eau douce

Fuel • Gasoil _____ 124 US Gallons - 470 l (approx.)

Exterior



Interior

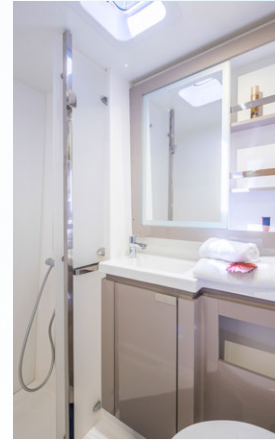

Quatuor

Layout

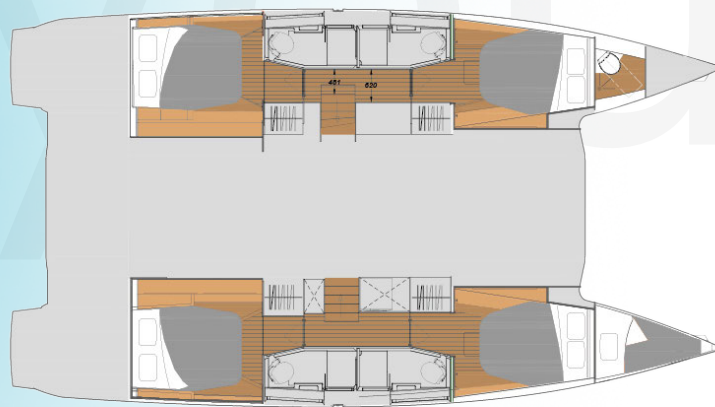

Quatuor

4 double cabins + 4 bathrooms

4 cabines doubles + 4 sdb

Option : 1 crew cabin



4+1



4



Saloon/Cockpit

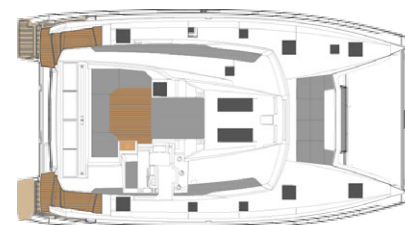

Deck



Options

↓ SKIPPER PERFORMANCE

RELAXED AND LUXURIOUS EXPERIENCE

DAYS

7/14

A captained charter with a crew offers a more relaxed and luxurious experience, as all of the sailing and maintenance tasks are taken care of by the crew.

This allows the charterer to simply sit back, relax, and enjoy the scenic views. The crew is also knowledgeable about the local area and can provide valuable recommendations for dining and other activities.

↓ HOSTESS

Opting for a charter with a hostess adds an extra touch of comfort and convenience to your yachting experience. A hostess onboard takes care of the domestic duties, allowing you to fully relax and enjoy your time on the yacht.

↓ BAREBOAT CHARTER

HANDS-ON AND ADVENTUROUS EXPERIENCE

DAYS

7/14

A bareboat charter provides a more hands-on and adventurous experience, where the charterer is responsible for the sailing and operation of the yacht. This option allows for greater flexibility and control over the itinerary, and is ideal for those with sailing experience.

It is important to note that charterers are responsible for all maintenance and safety tasks, and must have the necessary sailing experience and certifications.



DESTINATIONS

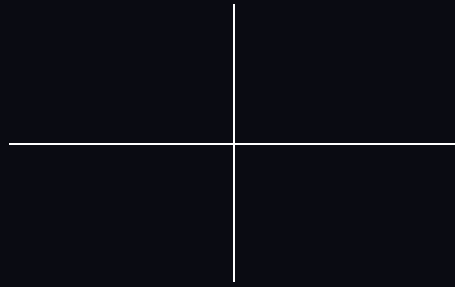

Cyclades

The famous archipelago of Greece lies in the blue waters of the Aegean Sea. With a total of 33 islands, Cyclades offers an unforgettable and adventurous experience. The typical architecture with the white and blue houses, sandy beaches, the Greek hospitality and barren lands are worth visiting. Each island has its own character, worth exploring.

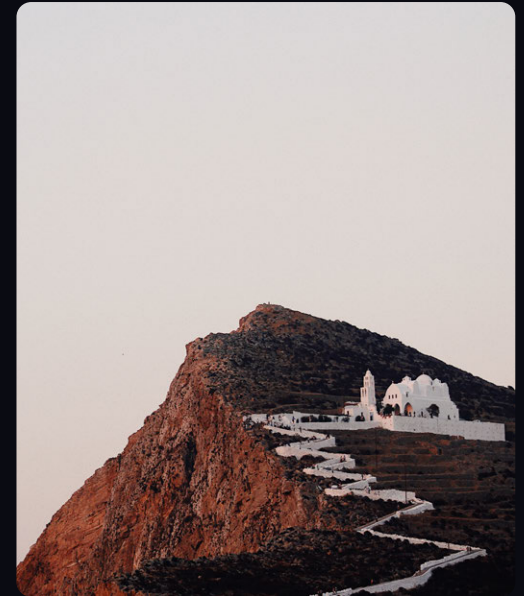

- Paros
- Naxos
- Kea
- Sifnos
- Kymolos
- Milos
- Serifos
- Kythnos
- Koufonisia
- Mykonos
- Tinos
- Syros
- Ios
- Folegandros

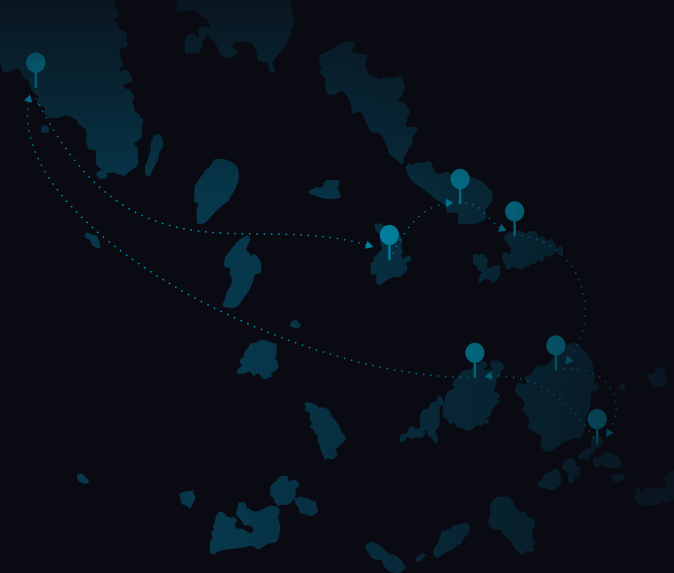



Saronic

In the blue waters of the Aegean Sea lie the Saronic Gulf islands between the peninsulas of Attica and Argolis. Delta Yachting takes you through the islands of Aegina, Agistri, Poros, Ermioni, Spetses, Porto Heli and Hydra.

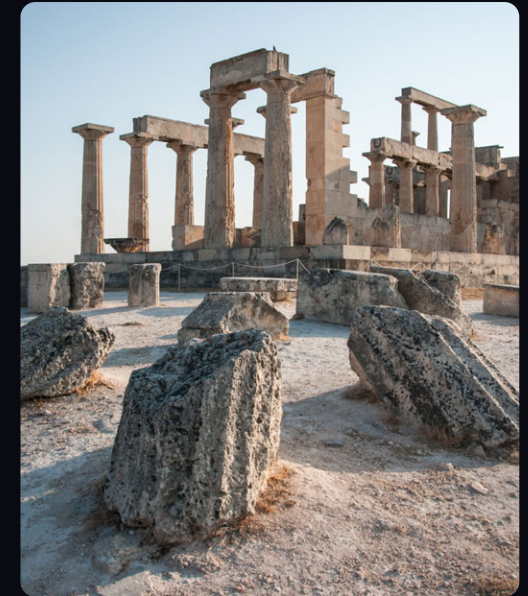

- Aegina
- Agistri
- Poros
- Spetses
- Hydra





CONTACT DETAILS

LOCATION
ATHENS, GREECE

DAYS
MON - SUN

PHONE

+30 (693) 678 6444

EMAIL

INFO@DELTAYACHTING.GR

WEBSITE

WWW.DELTAYACHTING.GR

SOCIAL MEDIA

